

MANIFOLD & MONOFLANGE VALVES

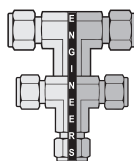

Page 2 to 5	Technical Information	Page 18	5 Valve Manifold Straight (5VM)
Page 6	2 Valve Manifold Straight (2VM)		Model - 5VMS
	Model - 2VMS1		Model - 5VMS-2E
	Model - 2VMS2		Model - 5VMS-PD
	Model - 2VMS3		Model - 5VMS-CP1
	Model - 2VMS4		Model - 5VMS-CP1-2E
	Model - 2VMS5		Model - 5VMS-CP1-PD
	Model - 2VMS6		Model - 5VMS-CP2
	Model - 2VMS7		Model - 5VMS-CP2-2E
	Model - 2VMSA		Model - 5VMS-CP2-PD
	Model - 2VME		Model - 5VMT
	Model - 2VMT1		Model - 5VMT-2E
	Model - 2VMT2		Model - 5VMT-PD
	Model - 2VMT-CP1		Model - 5VMT-CP1
	Model - 2VMT-CP2		Model - 5VMT-CP1-2E
Page 13	3 Valve Manifold Straight (3VM)		Model - 2VMT-CP1-PD
	Model - 3VMS1		Model - 5VMH
	Model - 3VMS2		Model - 5VMH-2E
	Model - 3VMS2-CP1		Model - 5VMH-PD
	Model - 3VMS2-CP2	Page 27	Order Information
	Model - 3VMT	Page 28	Monoflange
	Model - 3VMT-CP1		Model - MF1
	Model - 3VMT-CP2		Model - MF2
	Model - 3VMT-CP3		Model - MF3
	Model - 3VMH		

INTRODUCTION

We expertise in manufacturing and supplying a wide variety of manifold valves as per the international quality standards. Our range of manifold valves includes 2 way and 3 way manifold valves. Made with stainless steel, carbon steel and duplex stainless steel materials, manifold valves are easy to install and maintain. We offer manifold valves in various dimensions and specifications. These valves find their application in various industries like chemical, like chemical, petrochemical, oil etc. and can be customized as per the need of the bulk buyers.

2-3-5 VALVE MANIFOLD

Range of Valve Manifolds offer a safe and economical method of installation to control and measure pressure of liquids and gaseous media. They are ruggedly manufactured and precision machined to the most exacting dimensional tolerance to ensure perfect installation and application

Valve Manifolds are functionally installed to control, measure, isolate, equalize, calibrate, drain, vent or differentiate the pressure of liquids and gases. Valve manifolds series offer 2, 3 and 5 valves configurations which come in remote mounting 'R' Type (Pipe to Pipe), 'T' Type (direct mounting) & 'H' type (Pipe to Flange & Flange to Flange) onto the instrument on 2-1/8" (54mm) centre.

TECHNICAL INFORMATION

- **Valve Body** - Forged one piece body construction (no welding) for High Strength.
- **Non Rotating tip design** - Which forms a bearing joint with the stem eliminates rotation between plug & seat at closure. This prevents scoring and galling up the valve seat and ensure long life in repetitive shut off service.
- **Safety Bonnet Lock** - Prevents accidental disassembly.
- **Stem thread Rolled & Hard Plated** - Provides additional strength & maximum service life.
- **Mirror Finish Stem, burnished to a 16RMS** - Extends packing life and smoothens stem operation.
- **Adjustable Packing Below Stem threads** - Prevents stem lubrication washout and isolates threads from process contamination.
- **Safety Back Seating** - Provides secondary stem seal in full open position, prevents stem blowout.
- **Stainless Steel Handle** - For proper actuation.
- **Body to Bonnet seal** - Metal to Metal constant compression, Isolates bonnet threads from system fluids and eliminates possible tensile.
- **Dust Cap** - Prevents contamination and lubricant washout out of bonnet assembly. Color Identification Green for equalizing, .for isolation,for drain / vent.

MATERIAL CONSTRUCTION

- **Handle** to minimize torque. (SS 316, Nylon knob handle optional)
- **Grub Screw** for Anti Vibration Hold (SS)
- **Dust Caps** to indicate application - Plastic.
- **Bonnet Pusher** Silver plated for Anti Galling / Freezing. (Material same as Bonnet)
- **Check Nut** (Material same as Bonnet)
- **Washer** (Material same as Bonnet)
- **Packing** Standard Teflon (Choice of Packing available. Refer Ordering Instructions)
- **Bonnet** with blow out proof Stem Design. (Material same as Body)
- **Spindle Non Rotating Tip** Thread Rolled and burnished, Shut-Off Tip standard (Material same as Bonnet.)
- **Locking Pin** (adjustable Locking Arrangement also available)
- **Body** (Choice of Material available. Refer Ordering Instructions)

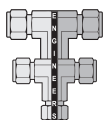

BONNET / VALVE ASSEMBLY

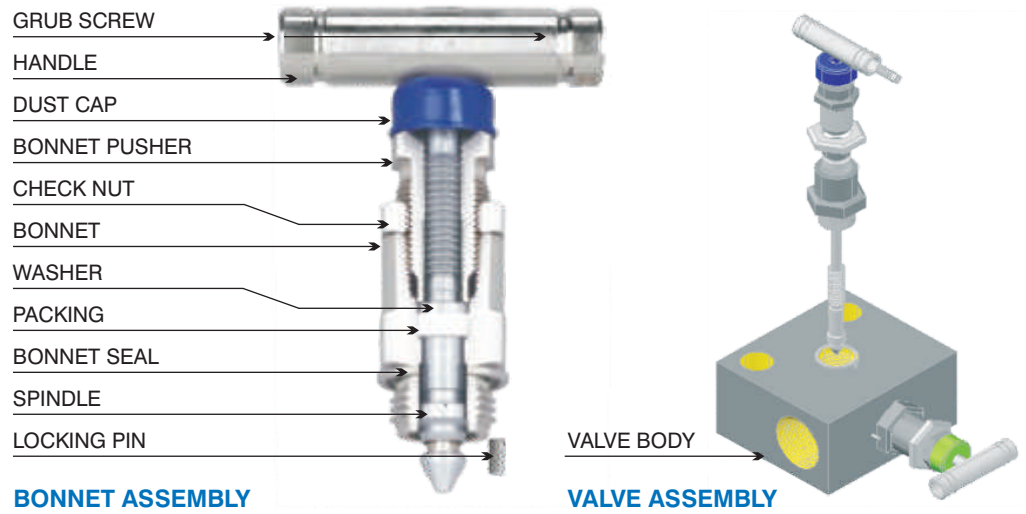

All parts precision machined with a hard seat designed to reduce packing friction giving very low torque operation. Stem seats to prevent unscrewing bonnet assembly of the stainless steel construction.

CAUTIONS

Control applications require a high response speed from flow measuring instruments hence mounting of these instruments is of paramount importance. Various types of transmitter mounting are available. However mounting the manifold to the pipe stand is recommended rather than connecting to the transmitter.

MANIFOLD FLANGE ADAPTER

These Adapter used to convert directly mounted Flange Manifold to separately mounted type with threaded end connection.

MANIFOLD & MONOFLANGE VALVES

TECHNICAL INFORMATION

SPINDLE TYPE (TIP) OPTION

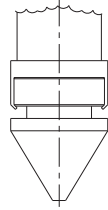

Type - CT

TYPE - CT

Stem for STANDARD needle pattern valves with a specially designed CONICAL MEAL END TIP.

Standard pressure up to 400 bar with a PTFE gland packing.

High pressure up to 700 bar.

Temperature limit is 550° C with Grafoil. Special valves for 20000 PSI.

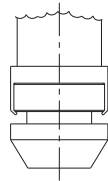

Type - DS

TYPE - DS

Stem design with a metal stem and conical end tip of DELRIN MATERIAL. The custom built soft needle tip is particularly effective on Gas Service.

Standard pressure up to 400 bar.

Temperature limit is 100° C

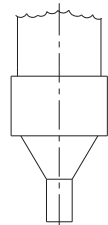

Type - Hpa

TYPE - Hpa

Two versions for high pressure applications specially designed stems ensuring long life and bubble tight sealing.

Pressure 700 bar at 100° C.

Pressure 400 bar at 240° C.

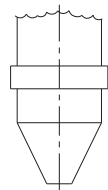

Type - YS

TYPE - YS

Standard needle pattern valves. The stem design is of minimum type and is a single piece design.

Standard pressure up to 200 bar max. with a PTFE gland packing.

Temperature limit is 240° C.

ACCESSORIES



Manifold Flange mounting Bolts
Bolts are used for VMT series Manifold
(Set of 4)



Manifold Flange mounting packing
Packing are used for VMT series Manifold
(Set of 2)

MANIFOLD FLANGE ADAPTER

These Adapter used to convert directly mounted Flange Manifold to separately mounted type with threaded end connection.

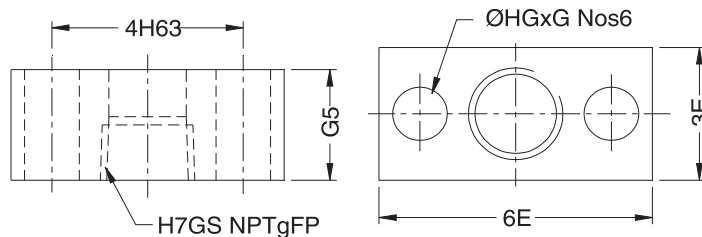
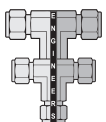

PRESSURE v/s. TEMPERATURE

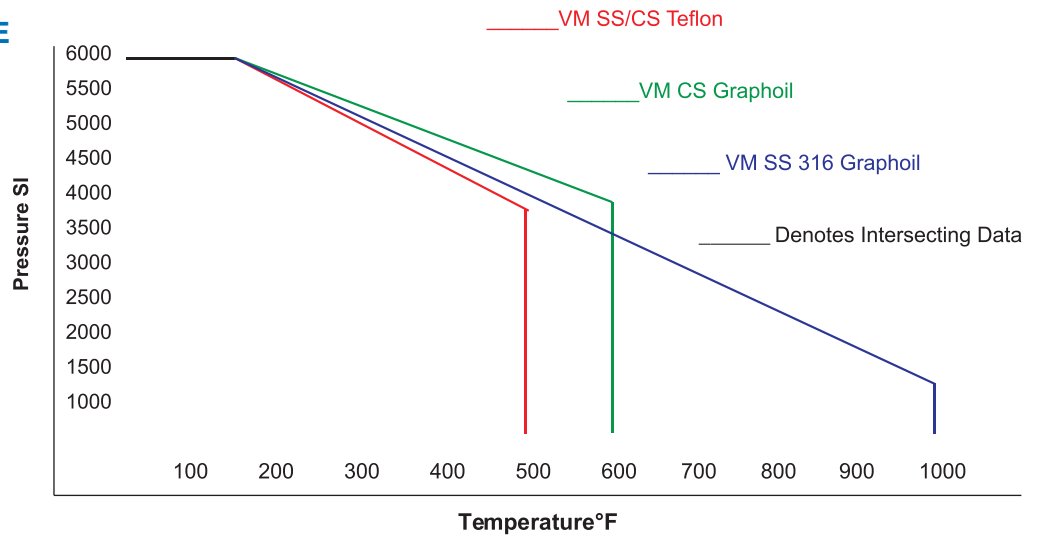

PRESSURE RATING

Temp7	C7S7	S7S7	Orifice	Cv
Room	6000 PSI	6000 PSI	4.8 mm	0.52 Max
500°F	4000 PSI	4000 PSI		
1000°F	1500 PSI	1500 PSI		

MANIFOLD SELECTION

Pressure and temperature rating are selected from ANSI B16.34 for Standard class valves based on ANSI B16-Class 2500.

Optional sour gas service confirms to NACE STD MR-01-75.

TESTING

Each valve is tested with nitrogen gas at 1000 psi for seat and packing leakage with a maximum allowable leak rate of 0.1 sec/min.

Hydro test performed with pure water at 1 and 1/2 times of working pressure. Other tests like vibration, temperatures, helium etc are available upon requests.

MATERIAL DESIGNATOR

Material	STAINLESS STEEL	CARBON STEEL	SS 316L	MONEL	HASTELLOY
Designator	SS	CS	SL	M	H

2 VALVE MANIFOLD (2VM)

Model - 2VMS1

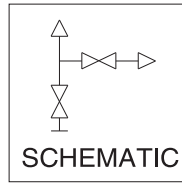

PR - Process (1/2"NPT-F)
IN - Instrument (1/2"NPT-F)
DR - Drain (1/2"NPT-F)

IS.V - Isolate Valves
D.V. - Drain Valve

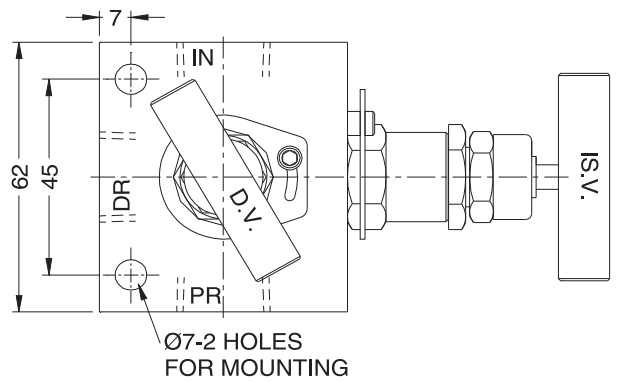
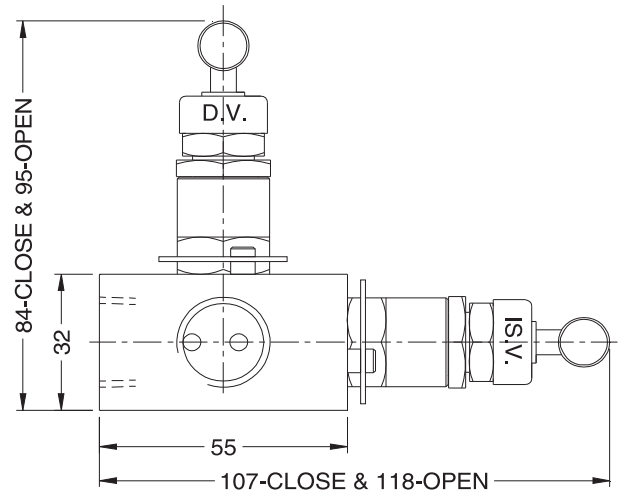

Model - 2VMS2

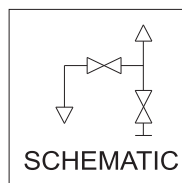

PR - Process (1/2"NPT-F)
IN - Instrument (1/2"NPT-F)
DR - Drain (1/2"NPT-F)

IS.V - Isolate Valves
D.V. - Drain Valve

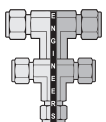
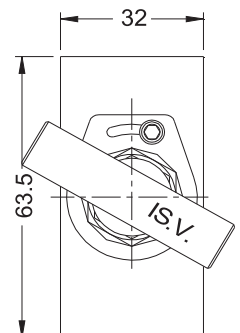
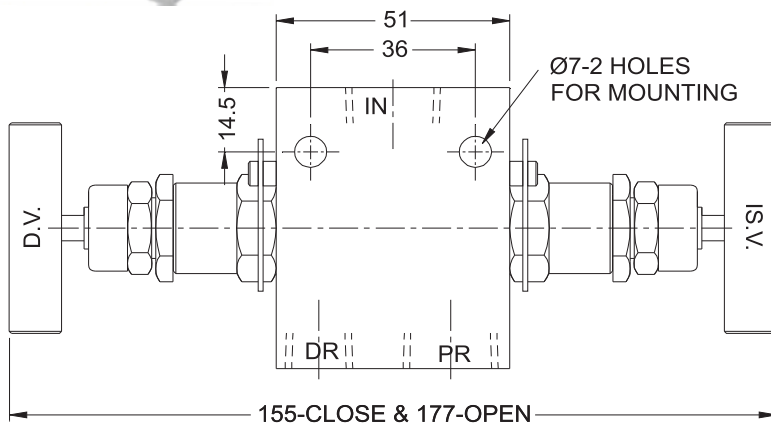

Model - 2VMS3

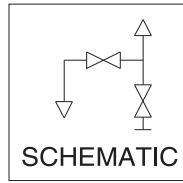

PR - Process (1/2"NPT-F)
IN - Instrument (1/2"NPT-F)
DR - Drain (1/2"NPT-F)

IS.V - Isolate Valves
D.V. - Drain Valve

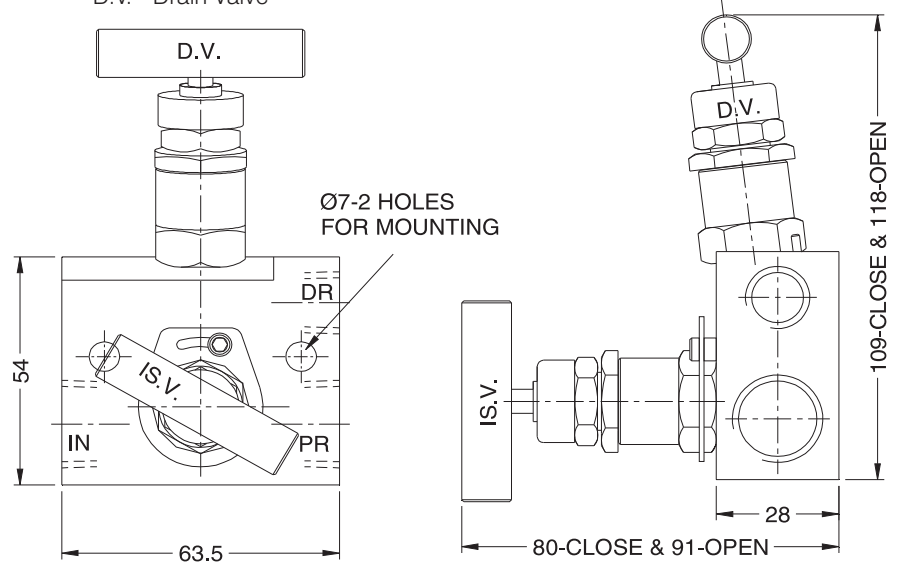

Model - 2VMS4

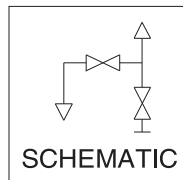

PR - Process (1/2"NPT-F)
IN - Instrument (1/2"NPT-F)
DR - Drain (1/2"NPT-F)

IS.V - Isolate Valves
D.V. - Drain Valve

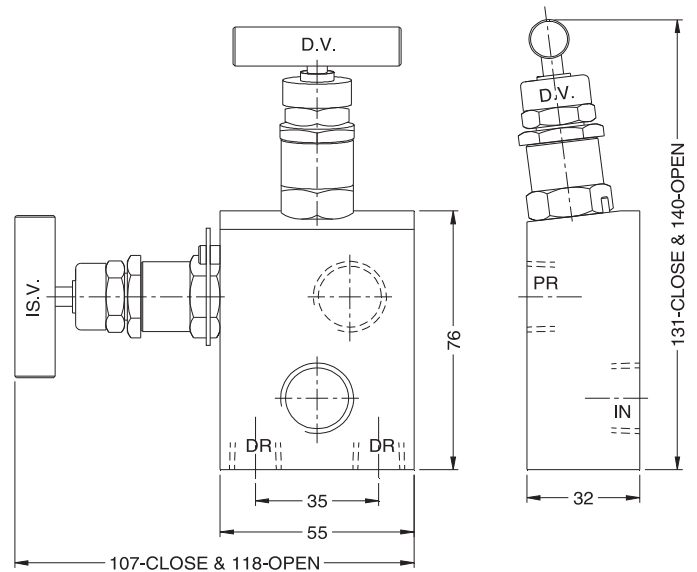

2 VALVE MANIFOLD (2VM)

Model - 2VMS5

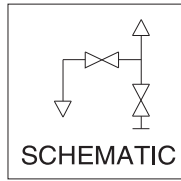

PR - Process (1/2"NPT-F)
IN - Instrument (1/2"NPT-F)
DR - Drain (1/2"NPT-F)

IS.V - Isolate Valves
D.V. - Drain Valve

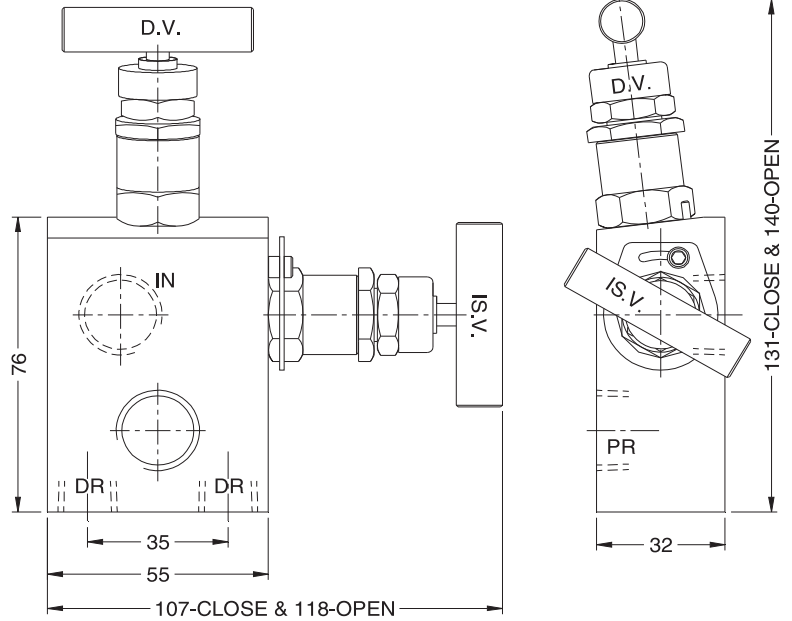

Model - 2VMS2

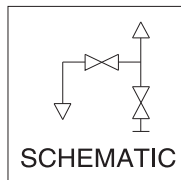

PR - Process (1/2"NPT-F)
IN - Instrument (1/2"NPT-F)
DR - Drain (1/2"NPT-F)

IS.V - Isolate Valves
D.V. - Drain Valve

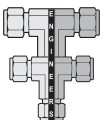
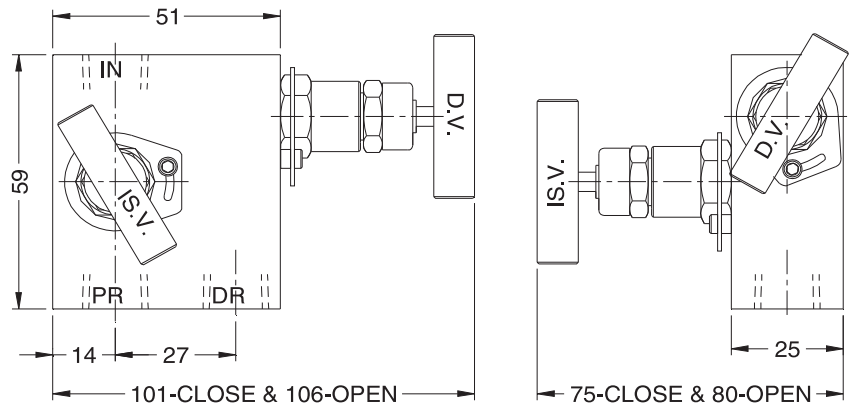

Model - 2VMS7

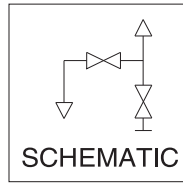

PR - Process (1/2" NPT-F)
IN - Instrument (1/2" NPT-F)
DR - Drain (1/4" NPT-F)
IS.V - Isolate Valves
D.V. - Drain Valve

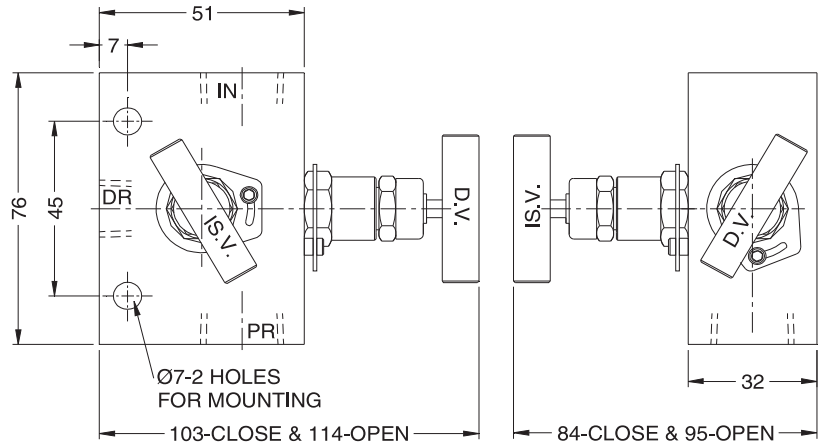

Model - 2VMSA

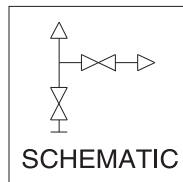

PR - Process (1/2" NPT-F)
IN - Instrument (1/2" NPT-F)
DR - Drain (1/2" NPT-F)

IS.V - Isolate Valves
D.V. - Drain Valve

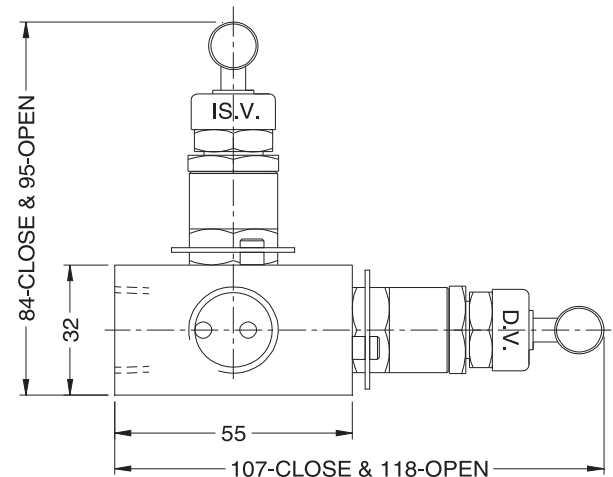
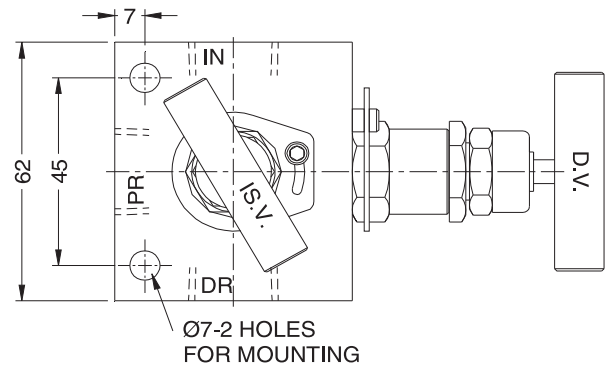

2 VALVE MANIFOLD (2VM)

Model - 2VME

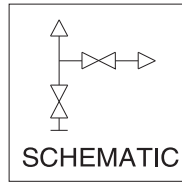

PR - Process (1/2"NPT-F)
IN - Instrument (1/2"NPT-F)
DR - Drain (1/4"NPT-F)

IS.V - Isolate Valves
D.V. - Drain Valve

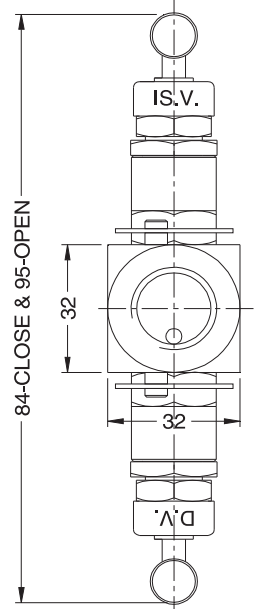
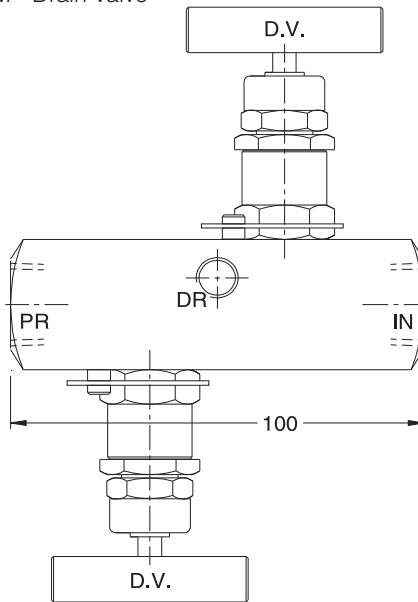

Model - 2VMT1

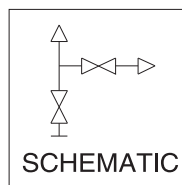

PR - Process (1/2"NPT-F)
IN - Instrument (Flange)
DR - Drain (1/4"NPT-F)

IS.V - Isolate Valves
D.V. - Drain Valve

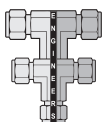
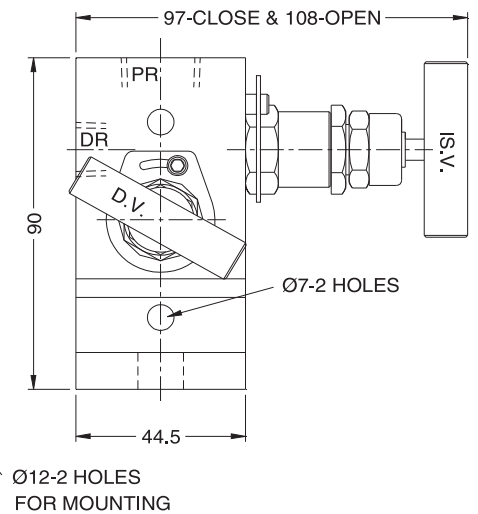
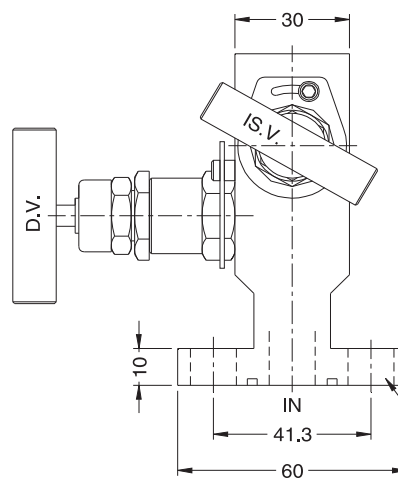

Model - 2VMT2

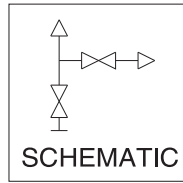

PR - Process (1/2"NPT-F)
IN - Instrument (Flange)
DR - Drain (1/4"NPT-F)
IS.V - Isolate Valves
D.V. - Drain Valve

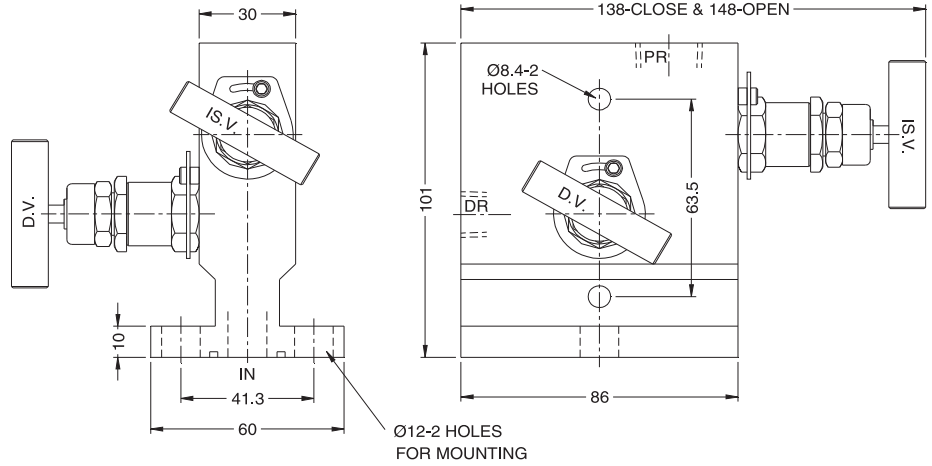

Model - 2VMT-CP1

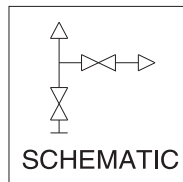

PR - Process (1/2"NPT-F)
IN - Instrument (Flange)
DR - Drain (1/4"NPT-F)
IS.V - Isolate Valves
D.V. - Drain Valve

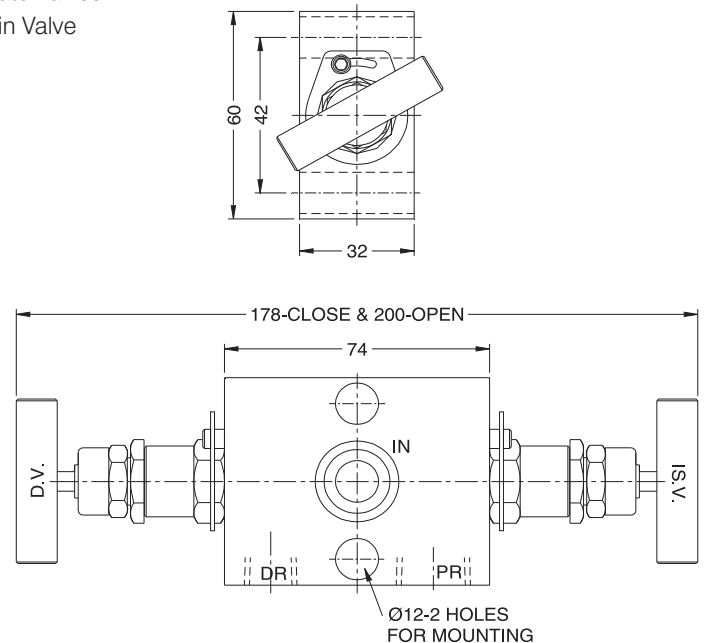
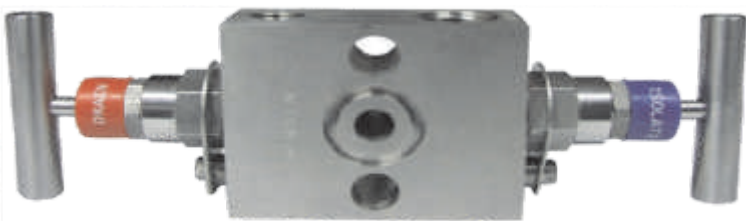

Model - 2VMT-CP2

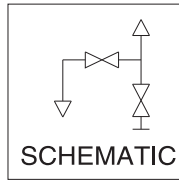

PR - Process (1/2"NPT-F)
IN - Instrument (Flange)
DR - Drain (1/4"NPT-F)

IS.V - Isolate Valves
D.V. - Drain Valve

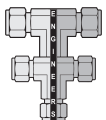
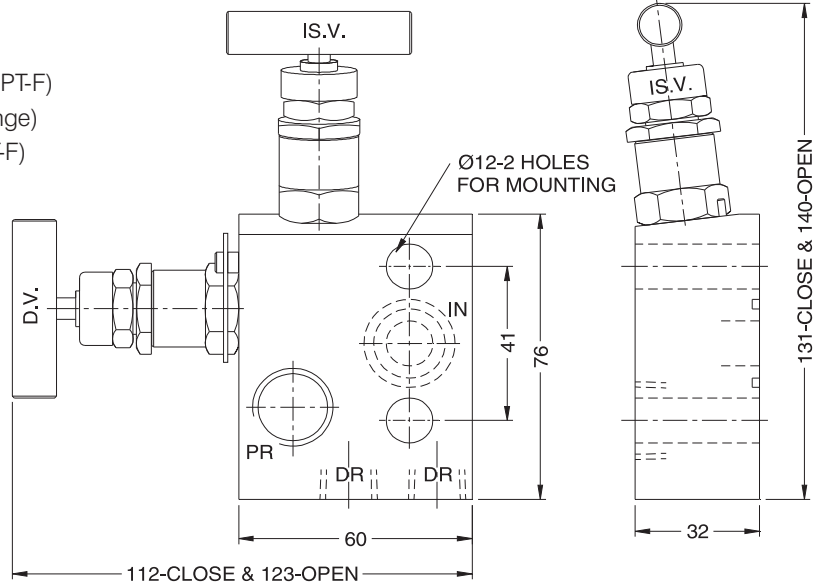

Model - 3VMS1

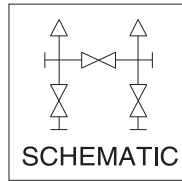

PR - Process (1/2" NPT-F)
IN - Instrument (1/2" NPT-F)
DR - Drain (1/4" NPT-F)



IS.V - Isolate Valves
D.V. - Drain Valve

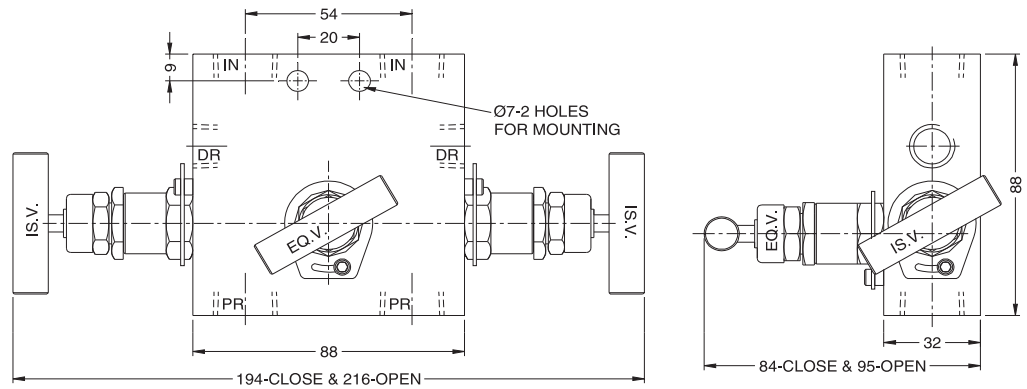

Model - 3VMS2

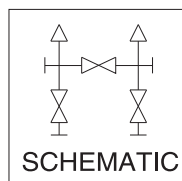

PR - Process (1/4" NPT-F)
IN - Instrument (1/4" NPT-F)
DR - Drain (1/4" NPT-F)



IS.V - Isolate Valves
D.V. - Drain Valve

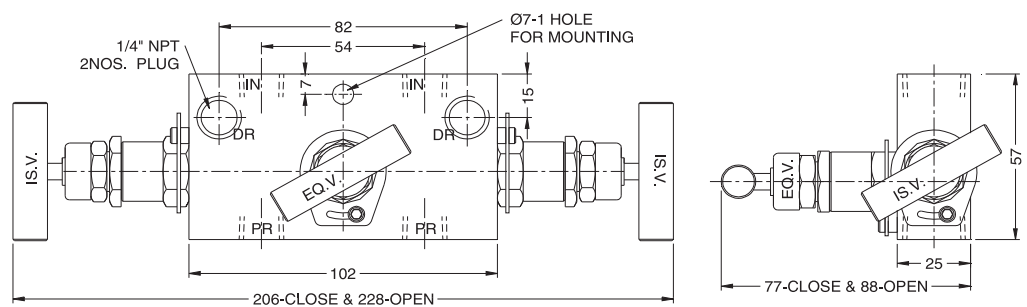

MANIFOLD & MONOFLANGE VALVES

3 VALVE MANIFOLD (3VM)

Model - 3VMS2-CP1

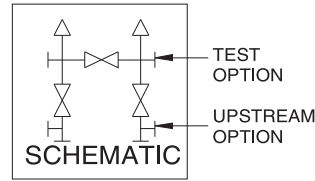

PR - Process (1/2" NPT-F)
 IN - Instrument (1/2" NPT-F)
 DR - Drain (1/2" NPT-F)

IS.V - Isolate Valves
 D.V. - Drain Valve

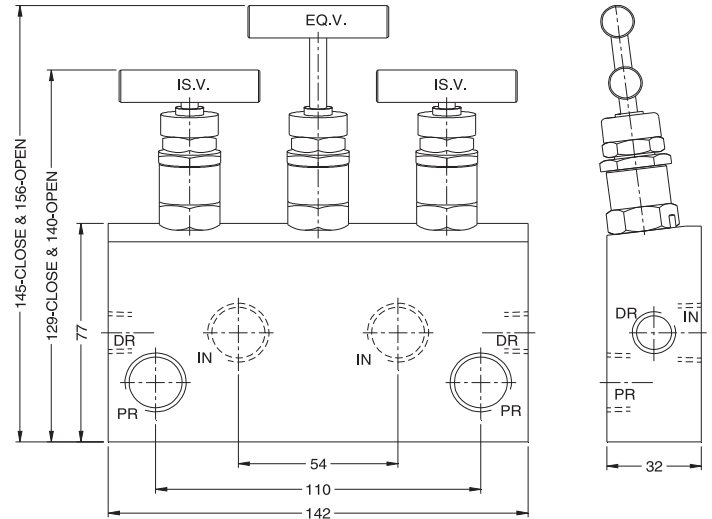

Model - 3VMS2-CP2

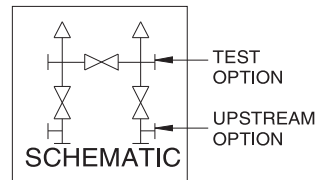

PR - Process (1/2" NPT-F)
 IN - Instrument (1/2" NPT-F)
 DR - Drain

IS.V - Isolate Valves
 D.V. - Drain Valve

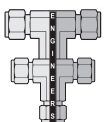
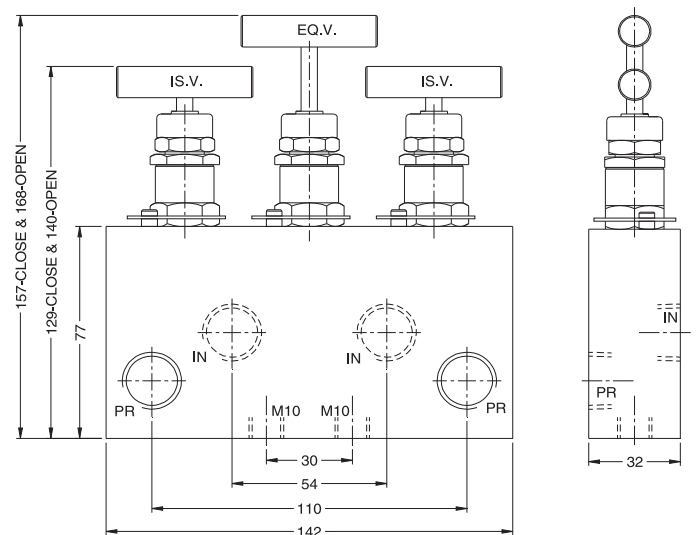

Model - 3VMT

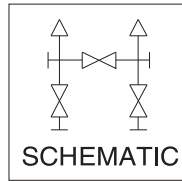

PR - Process (1/2" NPT-F)
IN - Instrument (Flange)
DR - Drain (1/4" NPT-F)

IS.V - Isolate Valves
D.V. - Drain Valve

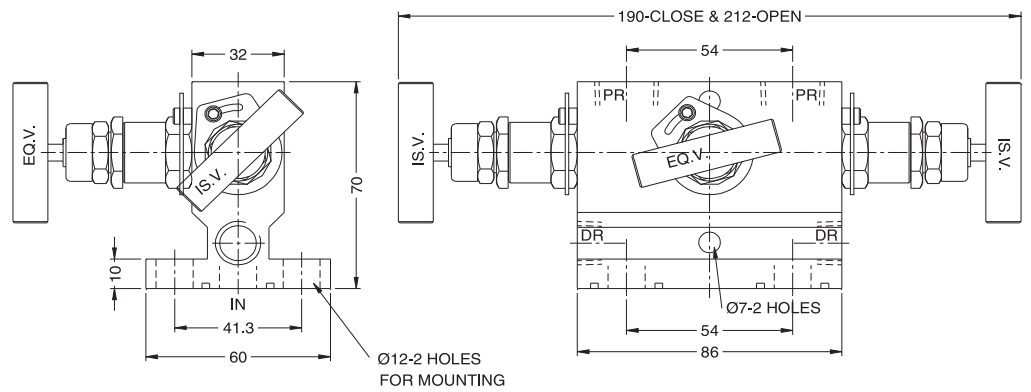

Model - 3VMT-CP1

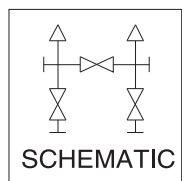

PR - Process (1/2" NPT-F)
IN - Instrument (1/2" NPT-F)
DR - Drain (1/4" NPT-F)

IS.V - Isolate Valves
D.V. - Drain Valve

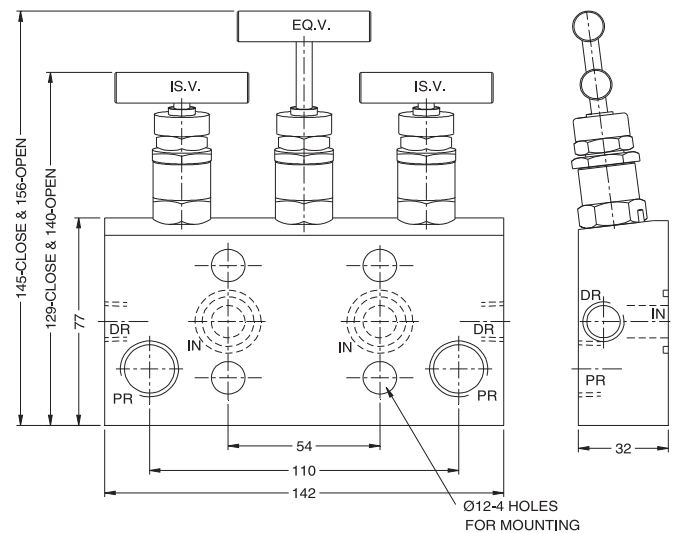

3 VALVE MANIFOLD (3VM)

Model - 3VMT-CP2

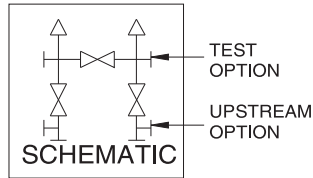

PR - Process (1/2" NPT-F)
IN - Instrument (1/2" NPT-F)
DR - Drain

IS.V - Isolate Valves
D.V. - Drain Valve

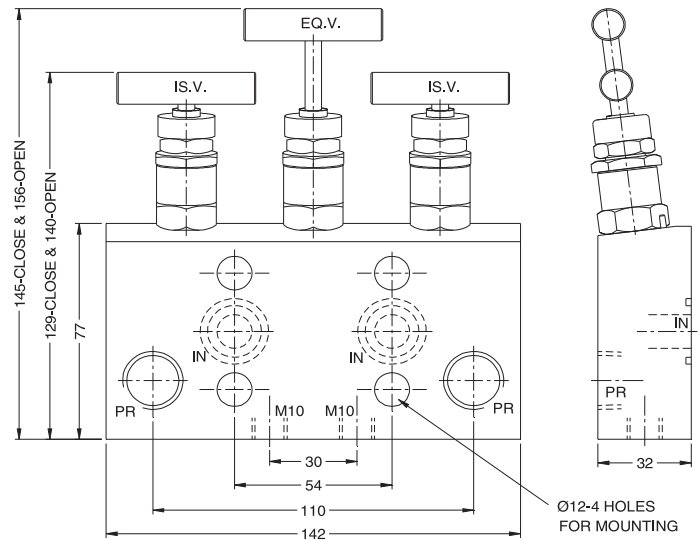

Model - 3VMT-CP3

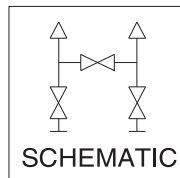

PR - Process (1/2" NPT-F)
IN - Instrument (1/2" NPT-F)
DR - Drain

IS.V - Isolate Valves
D.V. - Drain Valve

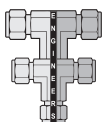

**FLUIDFIT
ENGINEERS PVT. LTD.**

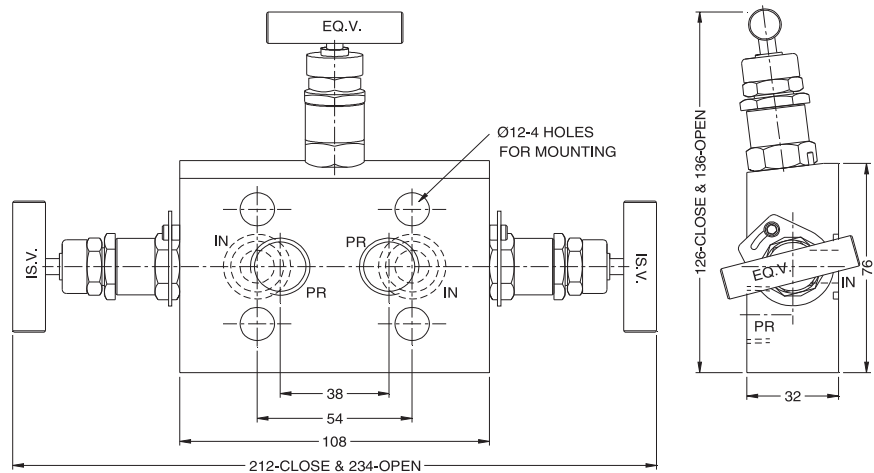

Model - 3VMH

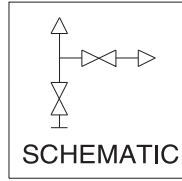

PR - Process (Flange)
IN - Instrument (Flange)
DR - Drain (1/4" NPT-F)

IS.V - Isolate Valves
D.V. - Drain Valve

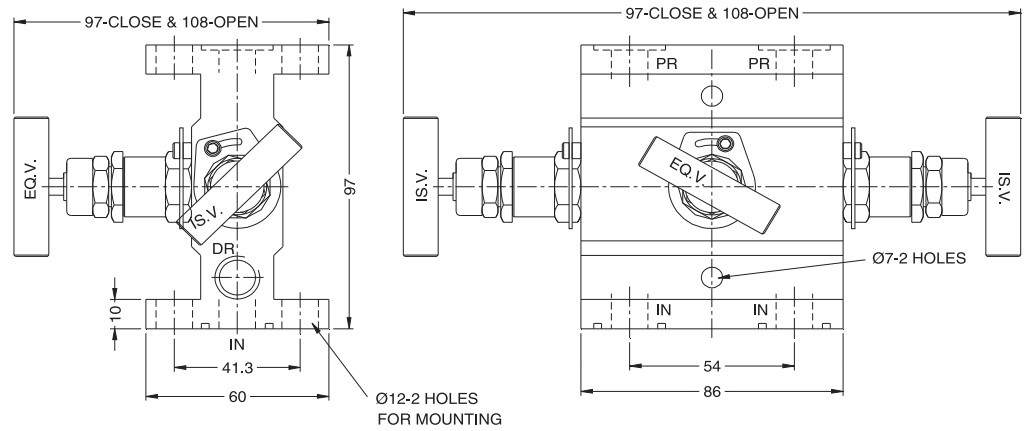

5 VALVE MANIFOLD (5VM)

Model - 5VMS

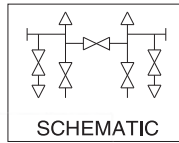

PR - Process (1/2" NPT-F)
IN - Instrument (1/2" NPT-F)
DR - Drain (1/4" NPT-F)

IS.V - Isolate Valves
D.V. - Drain Valve

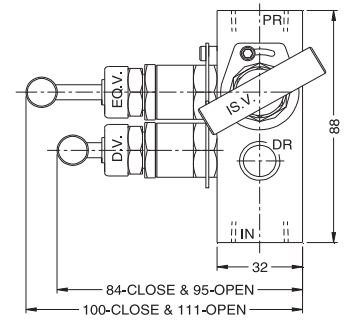
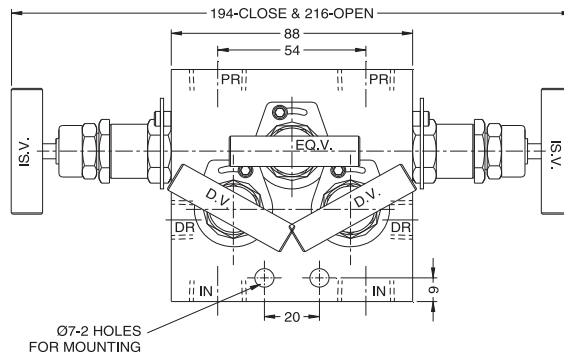

Model - 5VMS-2E

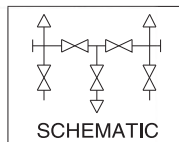

PR - Process (1/2" NPT-F)
IN - Instrument (1/2" NPT-F)
DR - Drain (1/4" NPT-F)

IS.V - Isolate Valves
D.V. - Drain Valve

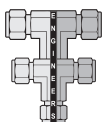
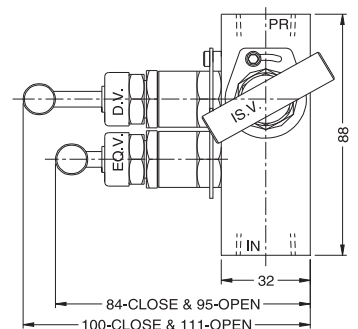
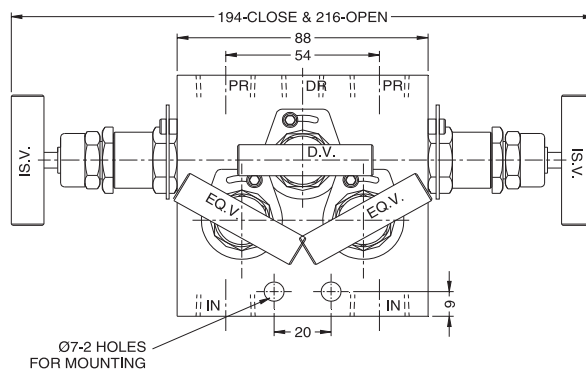
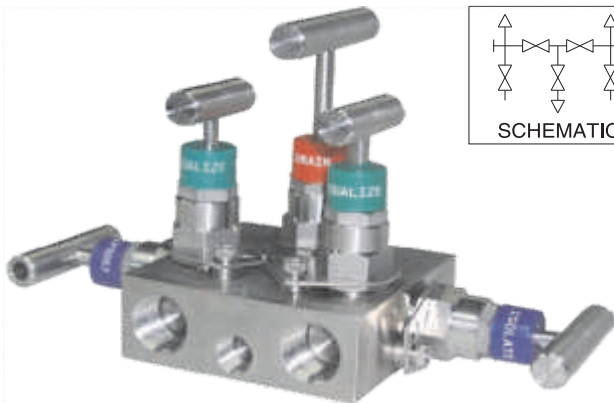

Model - 5VMS-PD

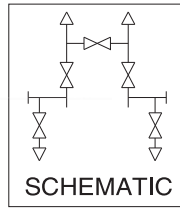

PR - Process (1/2" NPT-F)
IN - Instrument (1/2" NPT-F)
DR - Drain (1/4" NPT-F)
IS.V - Isolate Valves
D.V. - Drain Valve

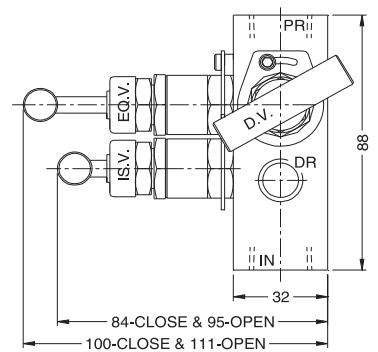
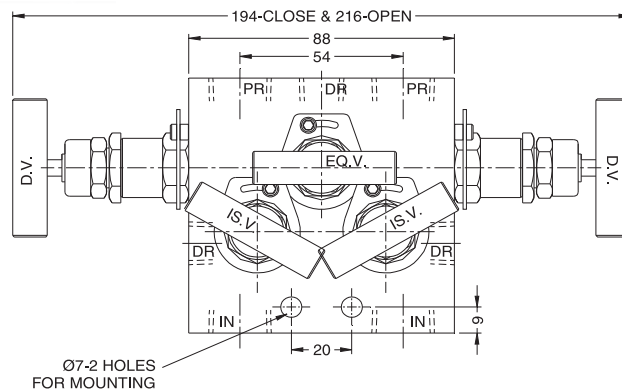

Model - 5VMS-CP1

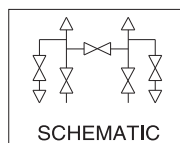

PR - Process (1/2" NPT-F)
IN - Instrument (1/2" NPT-F)
DR - Drain (1/4" NPT-F)
IS.V - Isolate Valves
D.V. - Drain Valve

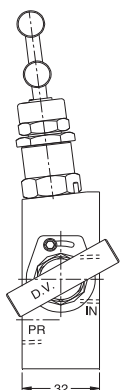
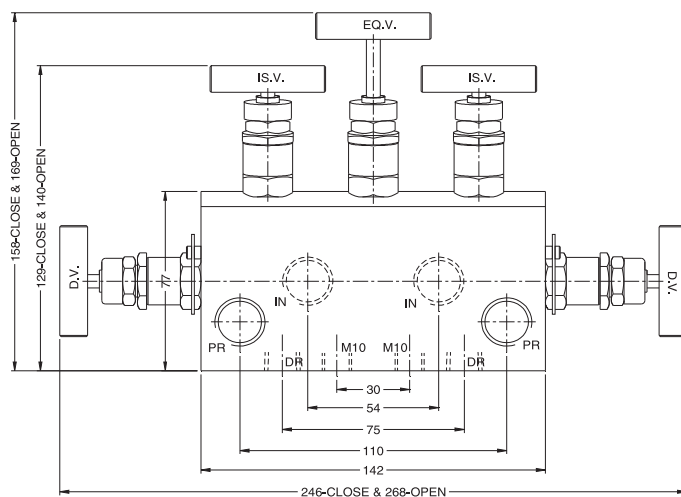

5 VALVE MANIFOLD (5VM)

Model - 5VMS-CP1-2E

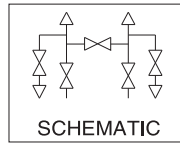

PR - Process (1/2" NPT-F)
IN - Instrument (1/2" NPT-F)
DR - Drain (1/4" NPT-F)

IS.V - Isolate Valves
D.V. - Drain Valve

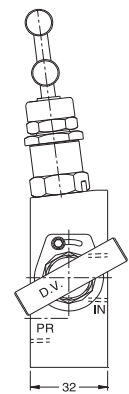
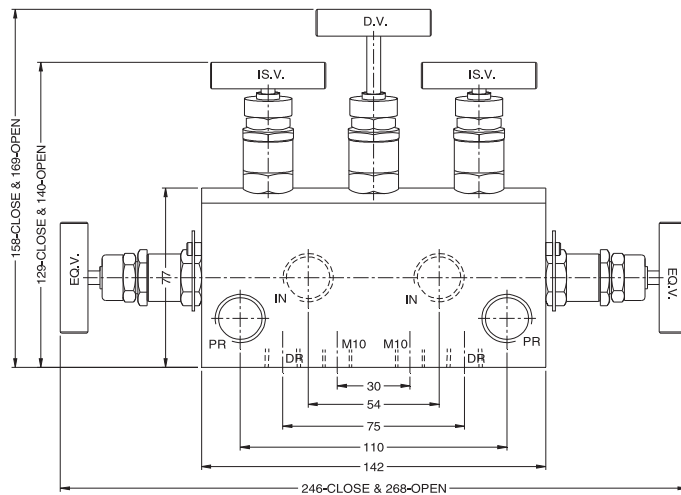
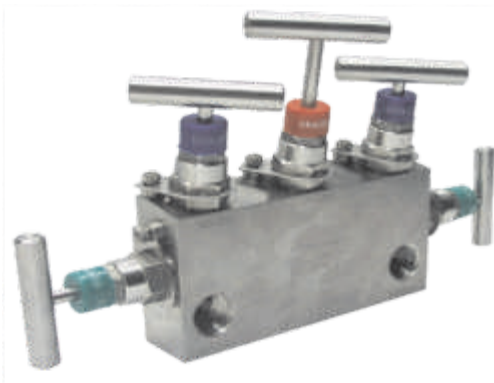

Model - 5VMS-CP1-PD

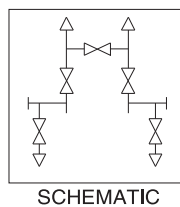

PR - Process (1/2" NPT-F)
IN - Instrument (1/2" NPT-F)
DR - Drain (1/4" NPT-F)

IS.V - Isolate Valves
D.V. - Drain Valve

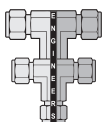
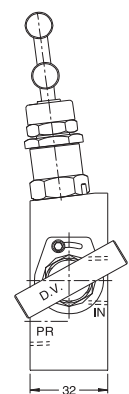
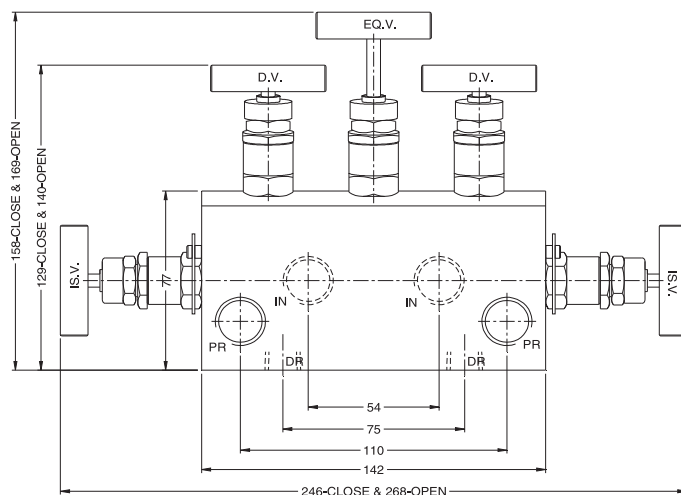
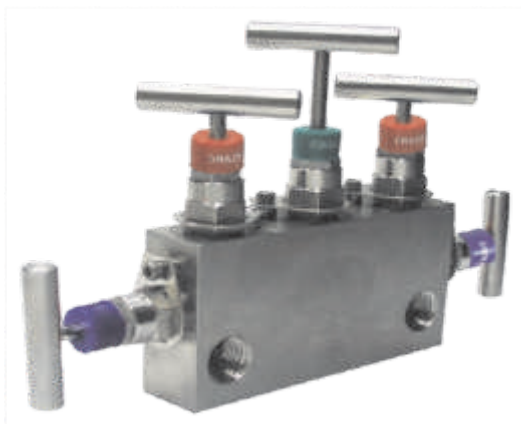

Model - 5VMS-CP2

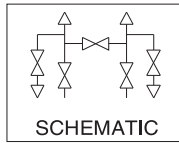

PR - Process (1/2" NPT-F)
IN - Instrument (1/2" NPT-F)
DR - Drain (1/4" NPT-F)

IS.V - Isolate Valves
D.V. - Drain Valve

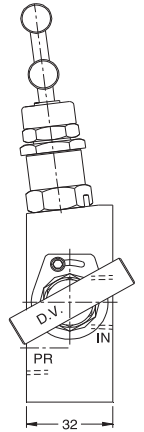
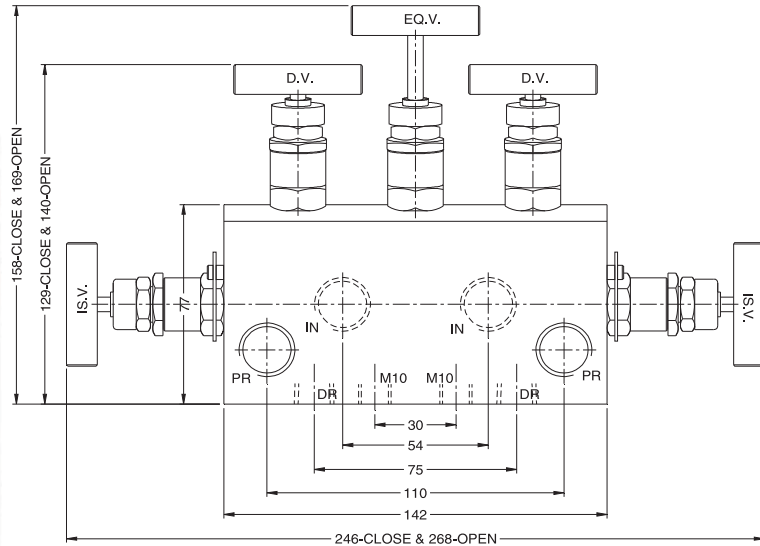
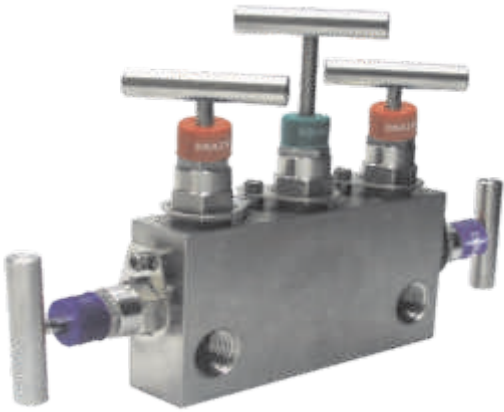

Model - 5VMS-CP2-2E

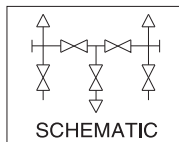

PR - Process (1/2" NPT-F)
IN - Instrument (1/2" NPT-F)
DR - Drain (1/4" NPT-F)

IS.V - Isolate Valves
D.V. - Drain Valve

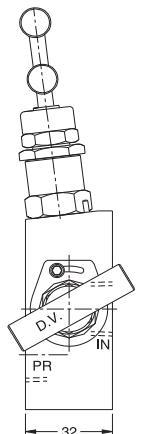
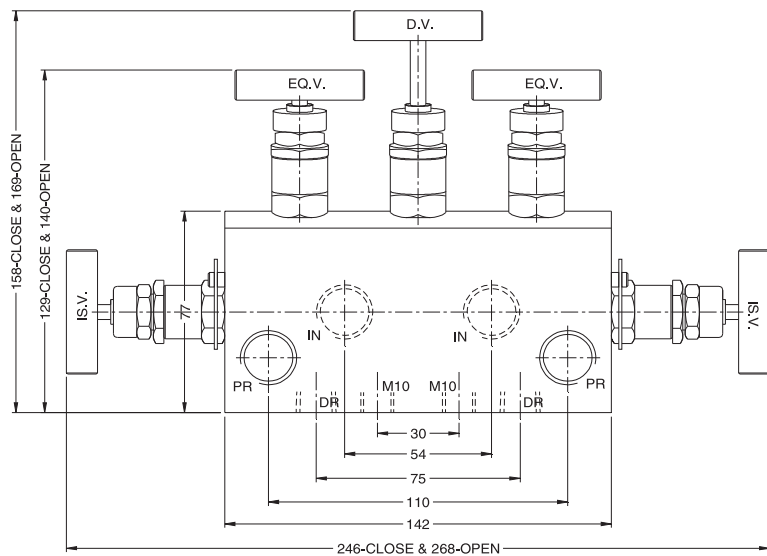

5 VALVE MANIFOLD (5VM)

Model - 5VMS-CP2-PD

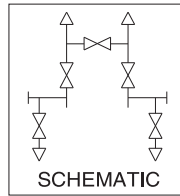

PR - Process (1/2"NPT-F)
IN - Instrument (1/2"NPT-F)
DR - Drain (1/4"NPT-F)
IS.V - Isolate Valves
D.V. - Drain Valve

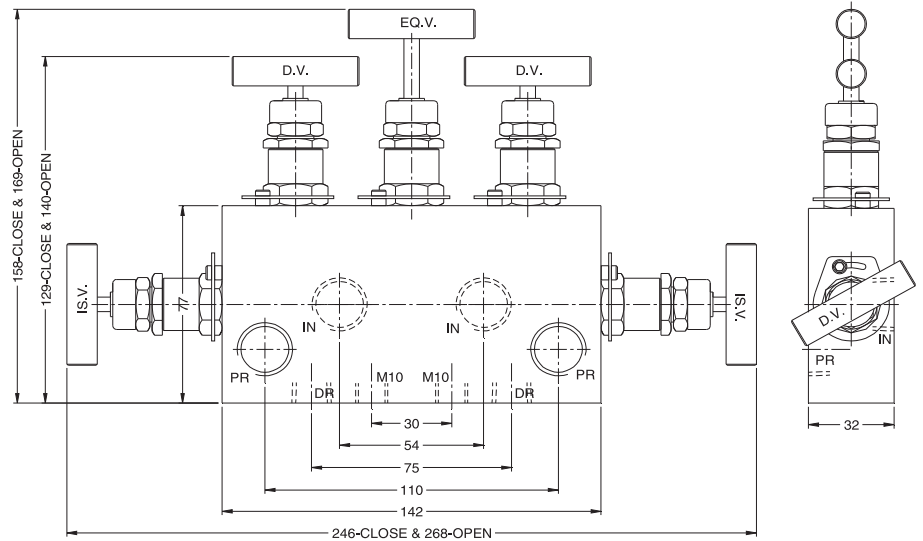
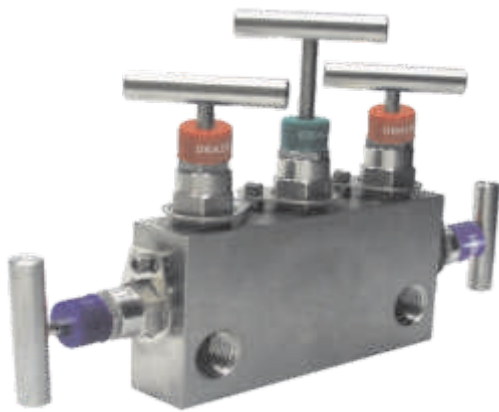

Model - 5VMT

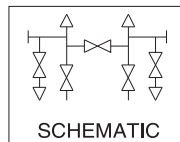

PR - Process (1/2"NPT-F)
IN - Instrument (1/2"NPT-F)
DR - Drain (1/4"NPT-F)
IS.V - Isolate Valves
D.V. - Drain Valve

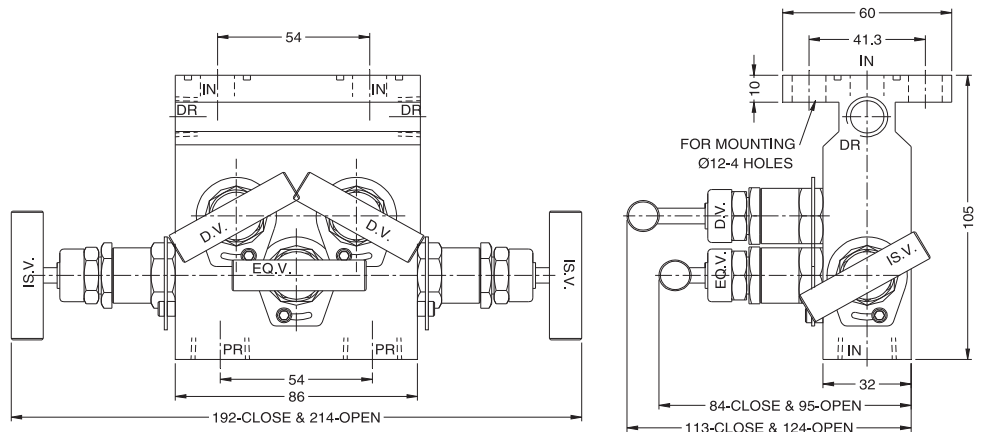
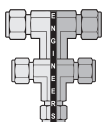

Model - 5VMT-2E

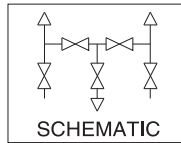

PR - Process (1/2"NPT-F)
IN - Instrument (1/2"NPT-F)
DR - Drain (1/4"NPT-F)

IS.V - Isolate Valves
D.V. - Drain Valve

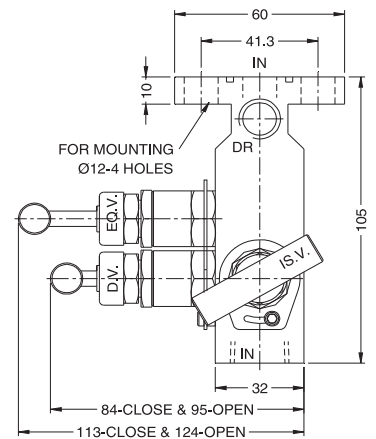
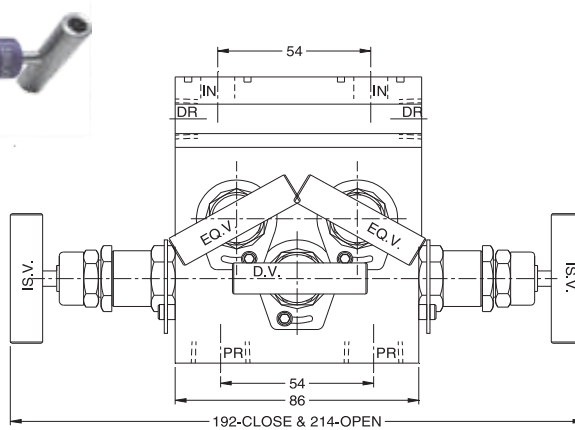

Model - 5VMT-PD

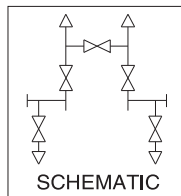

PR - Process (1/2"NPT-F)
IN - Instrument (1/2"NPT-F)
DR - Drain (1/4"NPT-F)

IS.V - Isolate Valves
D.V. - Drain Valve

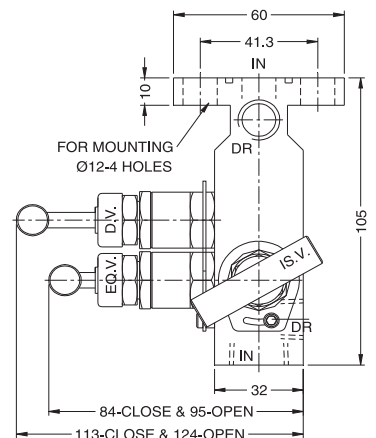
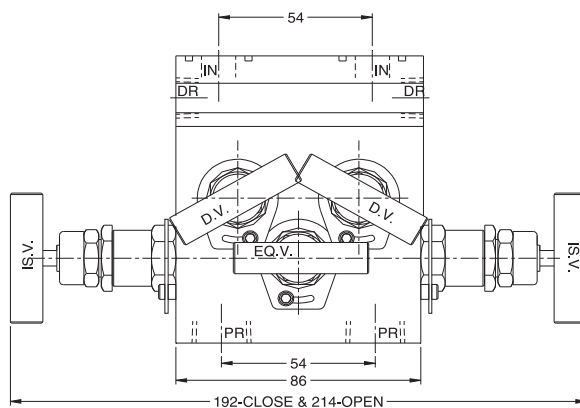

5 VALVE MANIFOLD (5VM)

Model - 5VMT-CP1

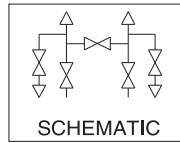

PR - Process (1/2"NPT-F)
IN - Instrument (1/2"NPT-F)
DR - Drain (1/4"NPT-F)

IS.V - Isolate Valves
D.V. - Drain Valve

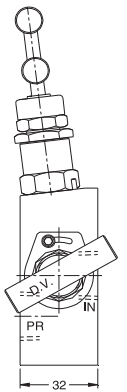
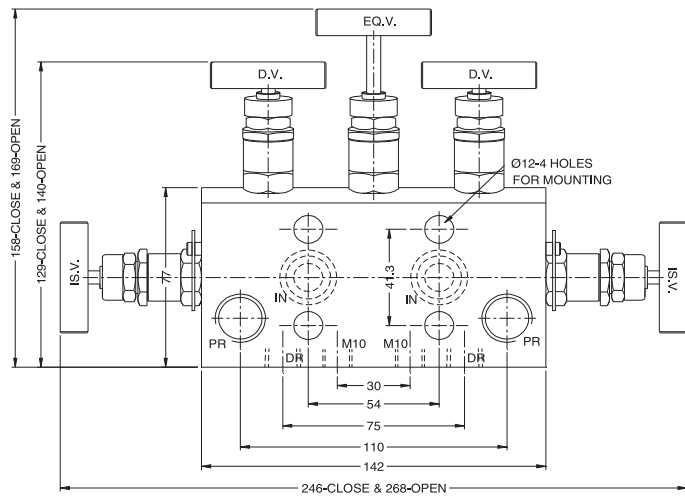
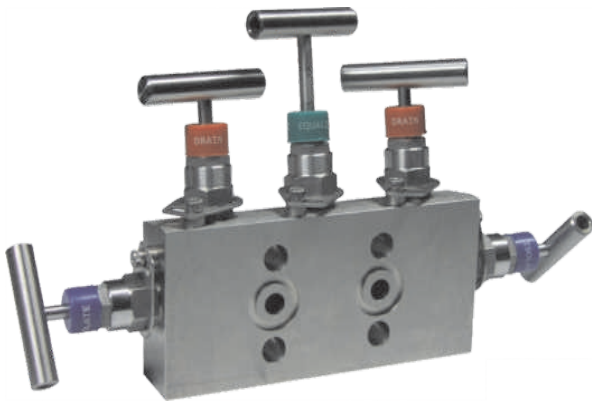

Model - 5VMT-CP1-2E

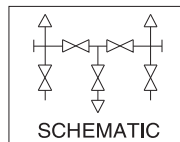

PR - Process (1/2"NPT-F)
IN - Instrument (1/2"NPT-F)
DR - Drain (1/4"NPT-F)

IS.V - Isolate Valves
D.V. - Drain Valve

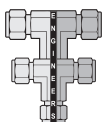
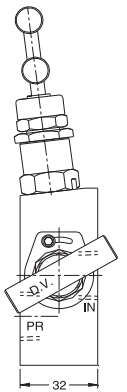
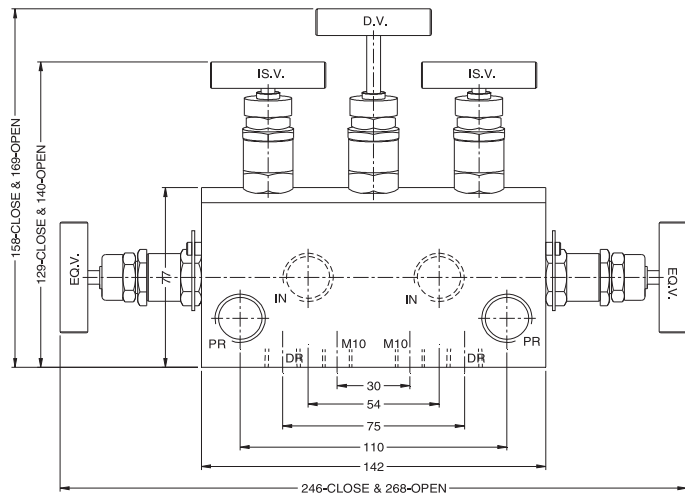
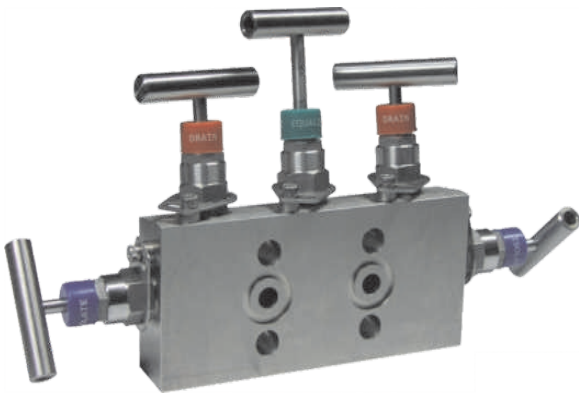

Model - 5VMT-CP2-PD

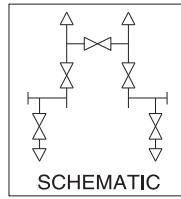

PR - Process (1/2"NPT-F)
IN - Instrument (1/2"NPT-F)
DR - Drain (1/4"NPT-F)
IS.V - Isolate Valves
D.V. - Drain Valve

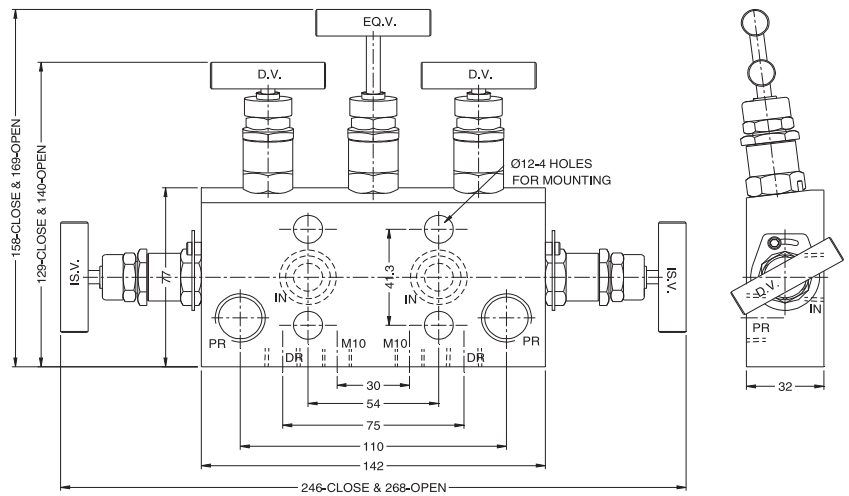
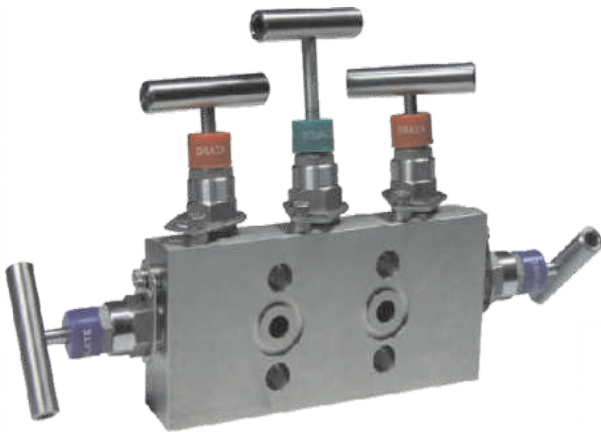

Model - 5VMH

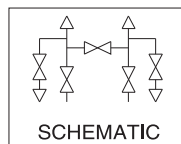

PR - Process (1/2"NPT-F)
IN - Instrument (1/2"NPT-F)
DR - Drain (1/4"NPT-F)
IS.V - Isolate Valves
D.V. - Drain Valve

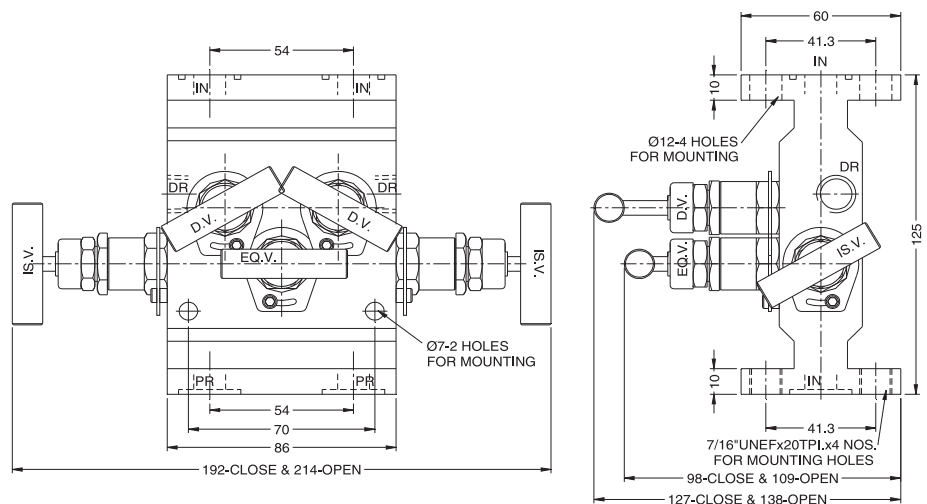

5 VALVE MANIFOLD (5VM)

Model - 5VMH-2E

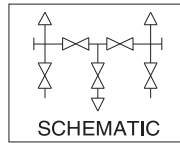

PR - Process (1/2"NPT-F)
IN - Instrument (1/2"NPT-F)
DR - Drain (1/4"NPT-F)

IS.V - Isolate Valves
D.V. - Drain Valve

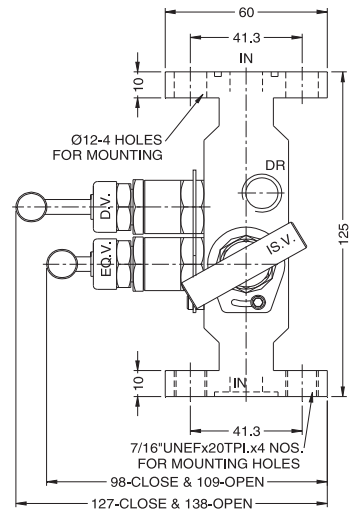
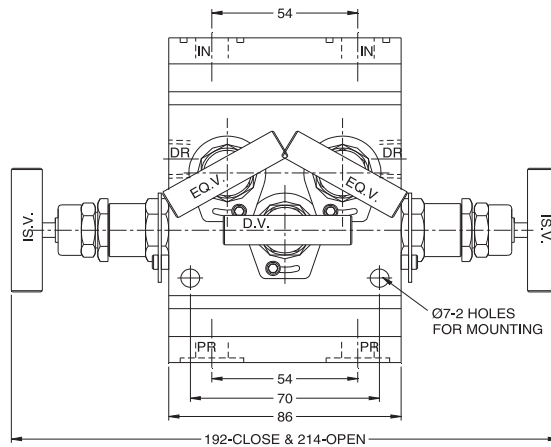

Model - 5VMH-PD

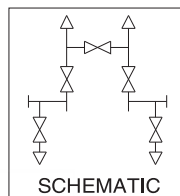

PR - Process (1/2"NPT-F)
IN - Instrument (1/2"NPT-F)
DR - Drain (1/4"NPT-F)

IS.V - Isolate Valves
D.V. - Drain Valve

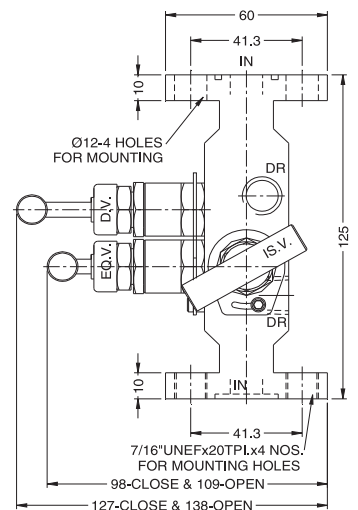
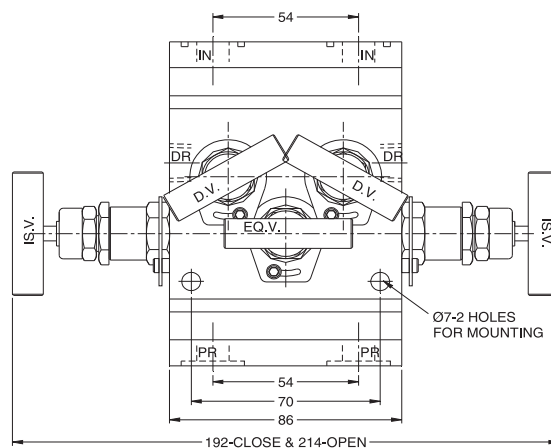
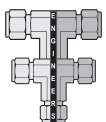

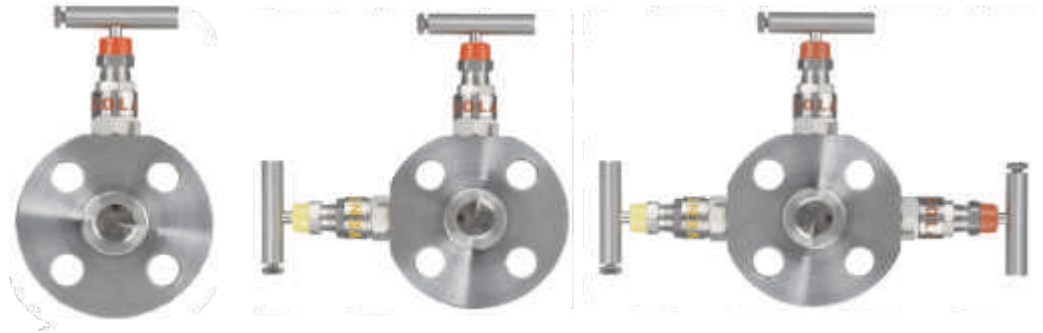

VALUE BODY

Integrally forged body or barstock body, Isolation valves for primary isolation of pressure take-offs, where the valve is directly mounted to the vessel or process pipe. Instruments may be directly mounted to the valve outlet or alternatively remotely mounted with gauge lines/impulse pipe work.

FLANGED CONNECTION

Available on inlet or inlet and outlet in a choice of size and ratings to suit each particular application.

SEVERS SERVICE (SS) NEEDLE TYPE GLOBE VALVES

Designed and tested to fire safe standards, ensures a bubble-tight open-close on isolation and vent service.

GAUGE ADAPTORS

Allow flexible positioning of gauges and instruments with a choice of design available.

STANDARD FEATURES

1/2 inch NPT threaded female outlet as standard to ANSI/ASME B1.20.1. Material thickness to ANSI B16.34.

ORDERING INFORMATION

Mf1	-	S6		04A	-	04A	-	P	-	RT
Basic		Material		Inlet		Outlet		Packing		Tip
Part Number		Code		Connection		Connection				Options

MF1 = Basic Part Number : MF1, MF2, MF3

S6 = Material Code
Use Material Designator provided on page 6.

04A = Inlet or Outlet Connection
08 - 1/2"A- 150 lb (ANSI B16.5)
12 - 3/4"B - 300 lb (ANSI B16.5)
16 - 1"C - 600 lb (ANSI B16.5)
20 - 1.1/2"D - 900 lb (ANSI B16.5)
24 - 2"E - 1500 lb (ANSI B16.5)

P = Needle Valve Packing Material
P = PTFE (Standard available)
G = Grafoil ®

RT = Tip Options
ST = Shut-off (Standard available)
RT = Regulating Tip

Model - MF1

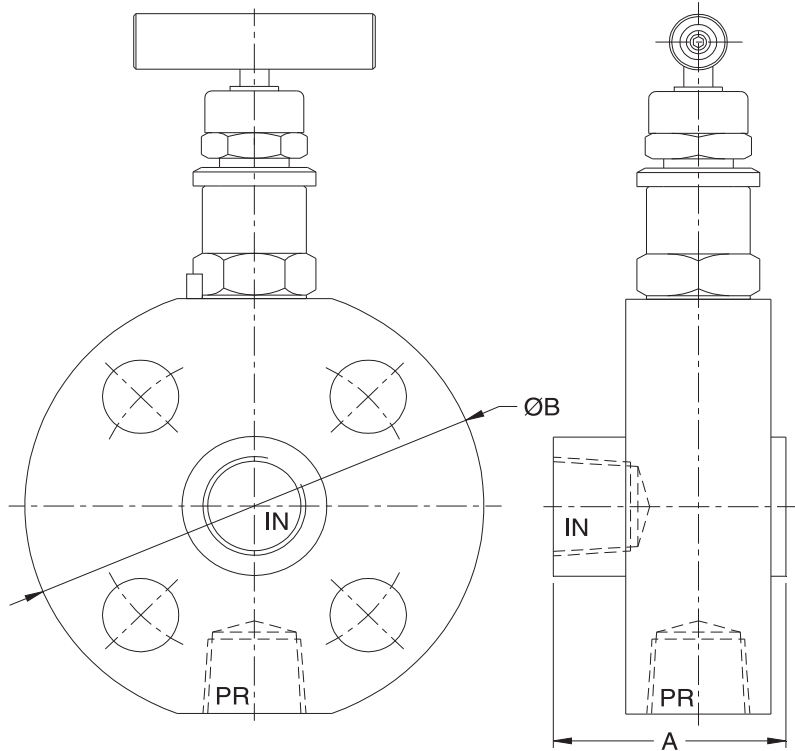

Size (in)	Rating (lb)	Dimensions (mm)		
		A (RF)	A (RTJ)	Dia. B
1/2	150	63.50	-	98.55
	300	63.50	67.56	98.55
	600	68.35	67.56	98.55
	900/1500	68.35	68.35	133.35
3/4	150	63.50	-	98.55
	300	63.50	68.35	133.35
	600	68.35	68.35	133.35
	900/1500	68.35	68.35	133.35
1	150	63.50	68.35	133.35
	300	63.50	68.35	133.35
	600	68.35	68.35	133.35
	900/1500	68.35	68.35	133.35
1.1/2	150	63.50	68.35	127.00
	300	68.52	68.52	158.75
	600	73.35	73.35	158.75
	900/1500	73.35	73.35	177.80
2	150	68.52	73.35	158.75
	300	68.52	74.92	177.80
	600	73.35	74.92	177.80
	900/1500	82.15	83.72	235.00

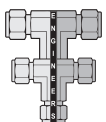

Model - 2VMT-CP1-PD

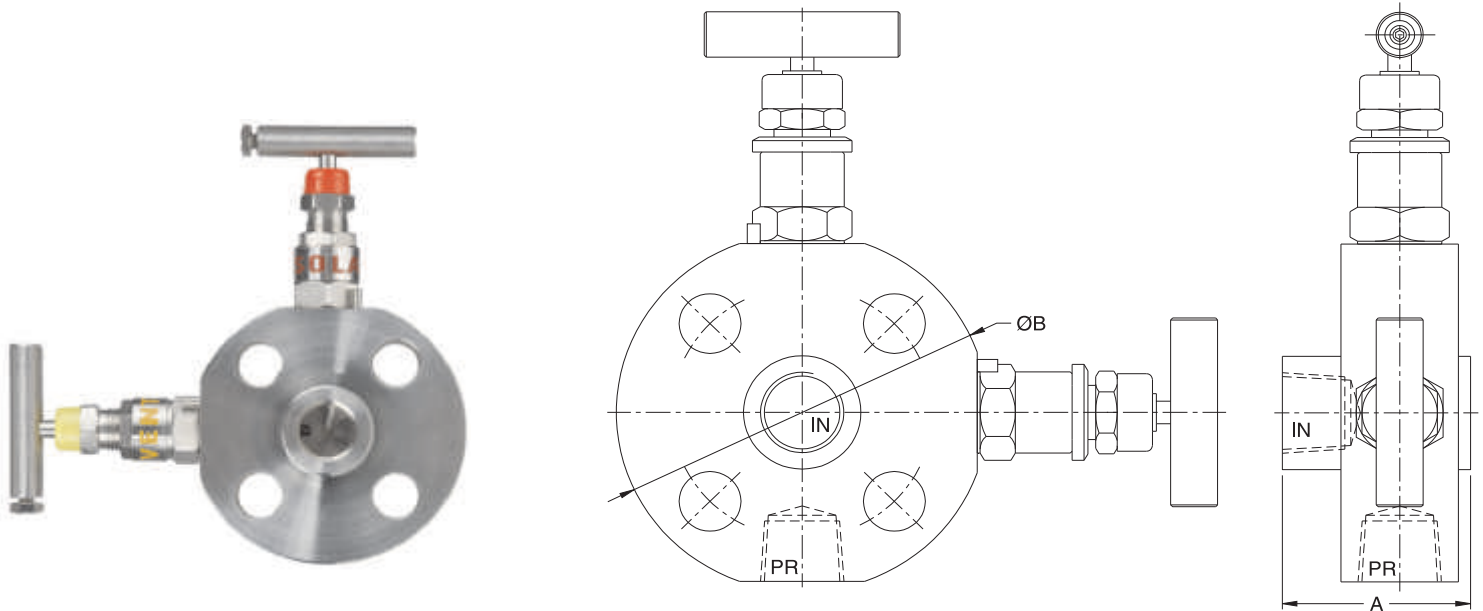

Size (in)	Rating (lb)	Dimensions (mm)		
		A (RF)	A (RTJ)	Dia. B
1/2	150	63.50	-	98.55
	300	63.50	67.56	98.55
	600	68.35	67.56	98.55
	900/1500	68.35	68.35	133.35
3/4	150	63.50	-	98.55
	300	63.50	68.35	133.35
	600	68.35	68.35	133.35
	900/1500	68.35	68.35	133.35
1	150	63.50	68.35	133.35
	300	63.50	68.35	133.35
	600	68.35	68.35	133.35
	900/1500	68.35	68.35	133.35
1.1/2	150	63.50	68.35	127.00
	300	68.52	68.52	158.75
	600	73.35	73.35	158.75
	900/1500	73.35	73.35	177.80
2	150	68.52	73.35	158.75
	300	68.52	74.92	177.80
	600	73.35	74.92	177.80
	900/1500	82.15	83.72	235.00

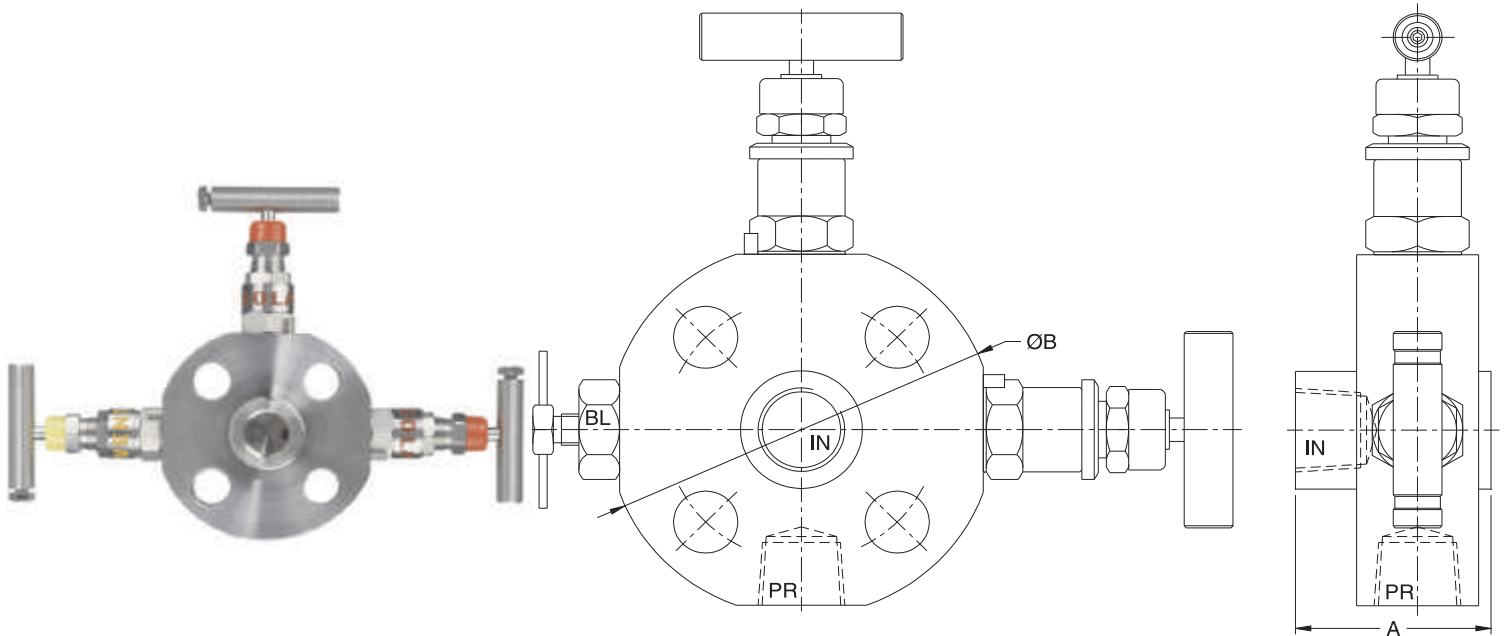

Size (in)	Rating (lb)	Dimensions (mm)		
		A (RF)	A (RTJ)	Dia. B
1/2	150	63.50	-	98.55
	300	63.50	67.56	98.55
	600	68.35	67.56	98.55
	900/1500	68.35	68.35	133.35
3/4	150	63.50	-	98.55
	300	63.50	68.35	133.35
	600	68.35	68.35	133.35
	900/1500	68.35	68.35	133.35
1	150	63.50	68.35	133.35
	300	63.50	68.35	133.35
	600	68.35	68.35	133.35
	900/1500	68.35	68.35	133.35
1.1/2	150	63.50	68.35	127.00
	300	68.52	68.52	158.75
	600	73.35	73.35	158.75
	900/1500	73.35	73.35	177.80
2	150	68.52	73.35	158.75
	300	68.52	74.92	177.80
	600	73.35	74.92	177.80
	900/1500	82.15	83.72	235.00

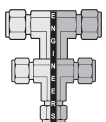

FLUIDLOK

MANIFOLD & MONOFLANGE VALVES

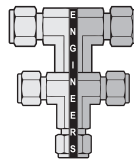
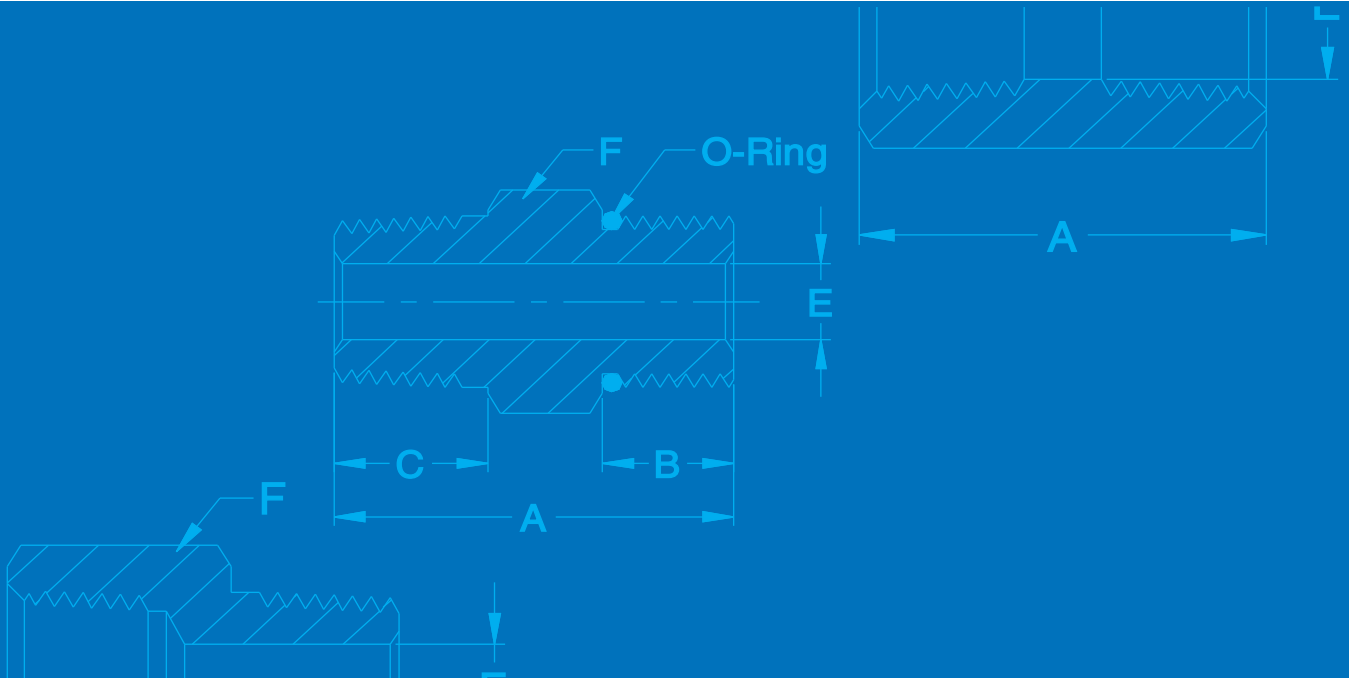

FLUIDFIT ENGINEERS PVT. LTD.

Unit #16, Supreme Industrial Estate, Near Bhajansons Diary, Kaman Bhiwandi Road,
Chinchoti Phata, Village Devdal, Vasai (E), Pin 201 208, India.

Tel : +91-9833852031 Fax: +91-22-23080308

E-mail : sales@fluidfitengg.com Web: www.fluidfitengg.com / www.valvesin.com



Catalogue #4MF(R2) 2011